

# Spare Parts | Trigon 105

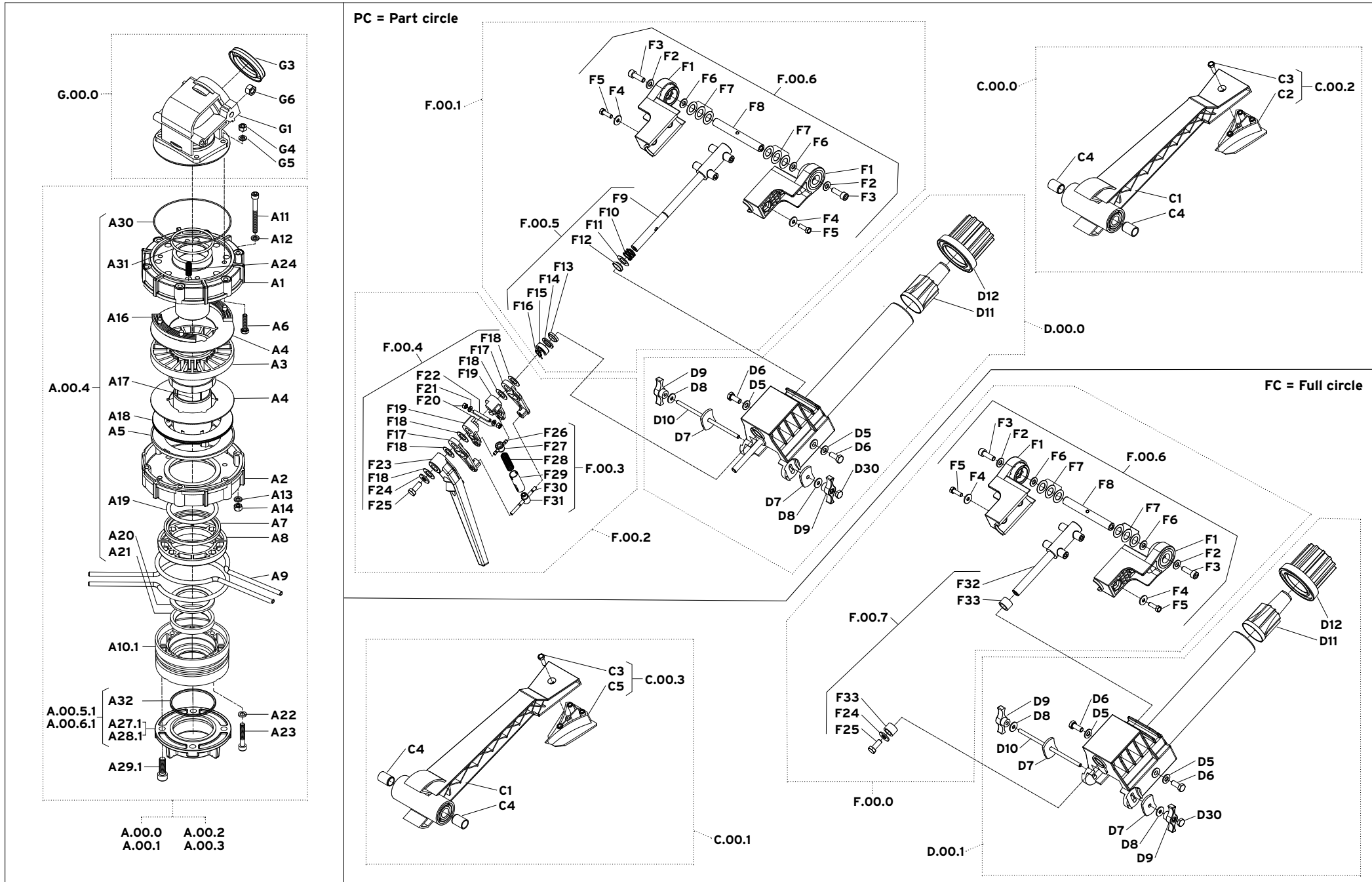

# Spare Parts | Trigon 105

|          | <b>ENGLISH</b><br>Description   | <b>DEUTSCH</b><br>Bezeichnung | <b>ITALIANO</b><br>Denominazione | <b>FRANCAIS</b><br>Désignation | <b>Q.ty</b><br><b>Stk.</b><br><b>Q.tà</b><br><b>Q.té</b> | <b>Part Number</b><br><b>Artikel-Nummer</b><br><b>Codice Articolo</b><br><b>Référence Pièce</b> |
|----------|---------------------------------|-------------------------------|----------------------------------|--------------------------------|--|---|
| A.00.0   | <b>Kit</b> Housing/2"NPT PC     | <b>Kit</b> Körper/2"NPT PC    | <b>Kit</b> Corpo/2"NPT PC        | <b>Kit</b> Corps/2"NPT PC      | 1  | 07010249  |
| A.00.1   | <b>Kit</b> Housing/2"BSP PC     | <b>Kit</b> Körper/2"BSP PC    | <b>Kit</b> Corpo/2"BSP PC        | <b>Kit</b> Corps/2"BSP PC      | 1  | 07010250  |
| A.00.2   | <b>Kit</b> Housing/2"NPT FC     | <b>Kit</b> Körper/2"NPT FC    | <b>Kit</b> Corpo/2"NPT FC        | <b>Kit</b> Corps/2"NPT FC      | 1  | 07010251  |
| A.00.3   | <b>Kit</b> Housing/2"BSP FC     | <b>Kit</b> Körper/2"BSP FC    | <b>Kit</b> Corpo/2"BSP FC        | <b>Kit</b> Corps/2"BSP FC      | 1  | 07010252  |
| A1       | Housing cover                   | Deckel für Körper             | Coperchio cuscinetto             | Couvercle corps                | 1  | 04010275  |
| A2       | Housing bearing                 | Lagergehäuse                  | Corpo cuscinetto                 | Corps roulement                | 1  | 04010274  |
| A3       | Collar bearing                  | Stützlager                    | Cuscinetto reggispinta           | Collier roulement              | 1  | 04010485  |
| A4       | Brake disk                      | Stahlscheibe für Bremse       | Disco freno                      | Disque frein                   | 2  | 02010332  |
| A5       | Support ring                    | Stützring                     | Anello sostegno disco            | Anneau soutien                 | 1  | 04010351  |
| A6       | Bolt M6x25                      | Schraube M6x25                | Vite M6x25                       | Vis M6x25                      | 4  | 02010230  |
| A7       | Retaining ring                  | Distanzring                   | Anello ritegno                   | Anneau de distance             | 1  | 04010277  |
| A8       | Collar for bearing              | Haltesegment für Bremslager   | Ghiera per cuscinetto            | Collier pour roulement         | 2  | 03010073  |
| A9       | Trip stop ring                  | Sektorring                    | Anello settore                   | Anneau secteur                 | 2  | 02010114  |
| A10.1    | Base                            | Sockel                        | Base                             | Base                           | 1  | 03010134  |
| A11      | Bolt M6x60                      | Schraube M6x60                | Vite M6x60                       | Vis M6x60                      | 6  | 02010229  |
| A12      | Washer 6                        | Scheibe 6                     | Rondella 6                       | Rondelle 6                     | 6  | 02010042  |
| A13      | Washer 6                        | Scheibe 6                     | Rondella 6                       | Rondelle 6                     | 6  | 02010042  |
| A14      | Nut M6                          | Mutter M6                     | Dado M6                          | Ecrou M6                       | 6  | 02010128  |
| A16      | Brake pad upper                 | Bremssegment oben             | Pastiglia freno superiore        | Pastille frein supérieure      | 2  | 04010378  |
| A17      | Bearing                         | Lager                         | Cuscinetto                       | Roulement                      | 1  | 04010276  |
| A18      | Brake lining                    | Bremsscheibe                  | Pastiglia freno                  | Pastille frein                 | 1  | 02010250  |
| A19      | O-Ring 6237                     | O-Ring 6237                   | O-Ring 6237                      | O-Ring 6237                    | 1  | 02010205  |
| A20      | Retaining ring                  | Stützring                     | Anello sostegno                  | Anneau de distance             | 1  | 04010352  |
| A21      | Lip seal                        | Lippen-Dichtung               | Guarnizione a labbro             | Joint à levre                  | 1  | 02010272  |
| A22      | Washer 6                        | Scheibe 6                     | Rondella 6                       | Rondelle 6                     | 4  | 02010042  |
| A23      | Bolt M6x35                      | Schraube M6x35                | Vite M6x35                       | Vis M6x35                      | 4  | 02010138  |
| A24      | Brake spring                    | Bremsfeder                    | Molla per freno                  | Ressort frein                  | 4  | 02010113  |
| A27.1    | Adapter/2"BSP                   | Anschluss/2"BSP               | Attacco/2"BSP                    | Raccord/2"BSP                  | 1  | 03010183  |
| A28.1    | Adapter/2"NPT                   | Anschluss/2"NPT               | Attacco/2"NPT                    | Raccord/2"NPT                  | 1  | 03010182  |
| A29.1    | Bolt M8x25                      | Schraube M8x25                | Vite M8x25                       | Vis M8x25                      | 4  | 02010176  |
| A30      | O-Ring 2425                     | O-Ring 2425                   | O-Ring 2425                      | O-Ring 2425                    | 1  | 02010206  |
| A31      | O-Ring 158                      | O-Ring 158                    | O-Ring 158                       | O-Ring 158                     | 1  | 02010207  |
| A32      | O-Ring 3225                     | O-Ring 3225                   | O-Ring 3225                      | O-Ring 3225                    | 1  | 02010111  |
| A.00.4   | <b>Kit</b> Brake                | <b>Kit</b> Bremse             | <b>Kit</b> Freno                 | <b>Kit</b> Frein               | 1  | 07010253  |
| A.00.5.1 | <b>Kit</b> Adapter thread 2"BSP | <b>Kit</b> Anschluss 2"BSP    | <b>Kit</b> Attacco 2"BSP         | <b>Kit</b> Raccord 2"BSP       | 1  | 07010808  |
| A.00.6.1 | <b>Kit</b> Adapter thread 2"NPT | <b>Kit</b> Anschluss 2"NPT    | <b>Kit</b> Attacco 2"NPT         | <b>Kit</b> Raccord 2"NPT       | 1  | 07010807  |
| C.00.0   | <b>Kit</b> Drive arm PC         | <b>Kit</b> Schwingarm PC      | <b>Kit</b> Braccio oscillante PC | <b>Kit</b> Bras oscillant PC   | 1  | 07010532  |
| C.00.1   | <b>Kit</b> Drive arm FC         | <b>Kit</b> Schwingarm FC      | <b>Kit</b> Braccio oscillante FC | <b>Kit</b> Bras oscillant FC   | 1  | 07010525  |
| C.00.2   | <b>Kit</b> Deflector PC         | <b>Kit</b> Deflektor PC       | <b>Kit</b> Deflettore PC         | <b>Kit</b> Déflecteur PC       | 1  | 07010355  |
| C.00.3   | <b>Kit</b> Deflector FC         | <b>Kit</b> Deflektor FC       | <b>Kit</b> Deflettore FC         | <b>Kit</b> Déflecteur FC       | 1  | 07010526  |
| C1       | Drive arm                       | Schwingarm                    | Braccio oscillante               | Bras oscillant                 | 1  | 04010291  |
| C2       | Deflector 36                    | Deflektor 36                  | Deflettore 36                    | Déflecteur 36                  | 1  | 04010293  |
| C3       | Screw EJ-K60x20                 | Schraube EJ-K60x20            | Vite EJ-K60x20                   | Vis EJ-K60x20                  | 1  | 02010166  |
| C4       | Bushing drive arm               | Büchse Schwingarm             | Boccola braccio osc.             | Douille bras oscillant         | 2  | 04010292  |
| C.00.4   | <b>Kit</b> Wind Deflector       | <b>Kit</b> Wind Deflektor     | <b>Kit</b> Vela antivento        | <b>Kit</b> Wind Déflecteur     | 1  | 07010608  |
| D.00.0   | <b>Kit</b> Barrel PC            | <b>Kit</b> Strahlrohr PC      | <b>Kit</b> Tubo di lancio PC     | <b>Kit</b> Fût PC              | 1  | 07010530  |
| D.00.1   | <b>Kit</b> Barrel FC            | <b>Kit</b> Strahlrohr FC      | <b>Kit</b> Tubo di lancio FC     | <b>Kit</b> Fût FC              | 1  | 07010527  |
| D5       | Washer 8                        | Scheibe 8                     | Rondella 8                       | Rondelle 8                     | 2  | 02010041  |
| D6       | Bolt M8x20                      | Schraube M8x20                | Vite M8x20                       | Vis M8x20                      | 2  | 02010036  |
| D7       | Plate 10'-26'                   | Platte 10'-26'                | Targhetta 10'-26'                | Plaque 10'-26'                 | 2  | 04010297  |
| D8       | Washer 6.5                      | Scheibe 6,5                   | Rondella 6.5                     | Rondelle 6.5                   | 2  | 02010160  |
| D9       | Butterfly screw                 | Flügelschraube                | Galletto                         | Vis                            | 2  | 04010299  |
| D10      | Shaft                           | Welle                         | Tirante                          | Pivot                          | 1  | 04010308  |
| D11.12   | Taper bore nozzle 12 mm / 0.47" | Weitwurfdüse 12 mm / 0.47"    | Ugello conico 12 mm / 0.47"      | Buse lng portée 12 mm / 0.47"  | 1  | 04010224  |
| D11.14   | Taper bore nozzle 14 mm / 0.55" | Weitwurfdüse 14 mm / 0.55"    | Ugello conico 14 mm / 0.55"      | Buse lng portée 14 mm / 0.55"  | 1  | 04010225  |
| D11.16   | Taper bore nozzle 16 mm / 0.63" | Weitwurfdüse 16 mm / 0.63"    | Ugello conico 16 mm / 0.63"      | Buse lng portée 16 mm / 0.63"  | 1  | 04010226  |
| D11.18   | Taper bore nozzle 18 mm / 0.71" | Weitwurfdüse 18 mm / 0.71"    | Ugello conico 18 mm / 0.71"      | Buse lng portée 18 mm / 0.71"  | 1  | 04010227  |
| D11.20   | Taper bore nozzle 20 mm / 0.79" | Weitwurfdüse 20 mm / 0.79"    | Ugello conico 20 mm / 0.79"      | Buse lng portée 20 mm / 0.79"  | 1  | 04010228  |
| D11.22   | Taper bore nozzle 22 mm / 0.87" | Weitwurfdüse 22 mm / 0.87"    | Ugello conico 22 mm / 0.87"      | Buse lng portée 22 mm / 0.87"  | 1  | 04010229  |
| D11.24   | Taper bore nozzle 24 mm / 0.94" | Weitwurfdüse 24 mm / 0.94"    | Ugello conico 24 mm / 0.94"      | Buse lng portée 24 mm / 0.94"  | 1  | 04010230  |
| D12      | Nozzle holder                   | Überwurfmutter                | Bocchettone                      | Ecrou buse                     | 1  | 04010280  |

## Spare Parts | Trigon 105

|        | ENGLISH<br>Description        | DEUTSCH<br>Bezeichnung          | ITALIANO<br>Denominazione            | FRANCAIS<br>Désignation           | Q.ty<br>Stk.<br>Q.tà<br>Q.té | Part Number<br>Artikel-Nummer<br>Codice Articolo<br>Référence Pièce |
|--------|-------------------------------|---------------------------------|--------------------------------------|-----------------------------------|------------------------------|---|
| D30    | Nut M6                        | Mutter M6                       | Dado M6                              | Ecrou M6                          | 2                            | 02010128  |
| F.00.0 | <b>Kit</b> Cross leverage FC  | <b>Kit</b> Gabel FC             | <b>Kit</b> Crociera FC               | <b>Kit</b> Fourche FC             | 1                            | 07010529  |
| F.00.1 | <b>Kit</b> Cross leverage PC  | <b>Kit</b> Gabel PC             | <b>Kit</b> Crociera PC               | <b>Kit</b> Fourche PC             | 1                            | 07010360  |
| F.00.2 | <b>Kit</b> Trip lever         | <b>Kit</b> Schalthebel          | <b>Kit</b> Leva settore              | <b>Kit</b> Levier inversion       | 1                            | 07010356  |
| F.00.3 | <b>Kit</b> Trip spring        | <b>Kit</b> Sektorfeder          | <b>Kit</b> Molla settore             | <b>Kit</b> Ressort inversion      | 1                            | 07010357  |
| F.00.4 | <b>Kit</b> Trip leverage      | <b>Kit</b> Sektorhebel          | <b>Kit</b> Leva settore              | <b>Kit</b> Levier inversion       | 1                            | 07010358  |
| F.00.5 | <b>Kit</b> Shaft PC           | <b>Kit</b> Welle PC             | <b>Kit</b> Perno PC                  | <b>Kit</b> Pivot PC               | 1                            | 07010359  |
| F.00.6 | <b>Kit</b> Fork for drive arm | <b>Kit</b> Gabel für Schwingarm | <b>Kit</b> Forcella per braccio Osc. | <b>Kit</b> Fourche pour bras osc. | 1                            | 07010361  |
| F.00.7 | <b>Kit</b> Shaft FC           | <b>Kit</b> Welle FC             | <b>Kit</b> Perno FC                  | <b>Kit</b> Pivot FC               | 1                            | 07010528  |
| F1     | Fork for drive arm            | Gabel für Schwingarm            | Forcella per braccio osc.            | Fourche pour bras oscillant       | 2                            | 04010284  |
| F2     | Washer 8                      | Scheibe 8                       | Rondella 8                           | Rondelle 8                        | 2                            | 02010041  |
| F3     | Bolt M8x25                    | Schraube M8x25                  | Vite M8x25                           | Vis M8x25                         | 2                            | 02010176  |
| F4     | Washer 6.5                    | Scheibe 6.5                     | Rondella 6.5                         | Rondelle 6.5                      | 2                            | 02010160  |
| F5     | Screw EJ-K60x20               | Schraube EJ-K60x20              | Vite EJ-K60x20                       | Vis EJ-K60x20                     | 4                            | 02010166  |
| F6     | Washer 8                      | Scheibe 8                       | Rondella 8                           | Rondelle 8                        | 2                            | 02010041  |
| F7     | Washer 0.7                    | Scheibe 0.7                     | Rondella 0.7                         | Rondelle 0.7                      | 6                            | 02010149  |
| F8     | Shaft drive arm               | Welle Schwingarm                | Perno braccio oscillante             | Pivot bras oscillant              | 1                            | 04010309  |
| F9     | Cross PC                      | Kreuzwelle PC                   | Crociera PC                          | Croisière PC                      | 1                            | 04010283  |
| F10    | Spring for fork               | Feder für Gabel                 | Molla per forcella                   | Ressort pour fourche              | 1                            | 02010245  |
| F11    | Washer 0.7                    | Scheibe 0.7                     | Rondella 0.7                         | Rondelle 0.7                      | 1                            | 02010149  |
| F12    | Dust seal                     | Abstreif-Dichtung               | Guarnizione raschiatore              | Joint antipoussière               | 1                            | 02010119  |
| F13    | Dust seal                     | Abstreif-Dichtung               | Guarnizione raschiatore              | Joint antipoussière               | 1                            | 02010119  |
| F14    | Washer                        | Scheibe                         | Rondella scorrimento                 | Rondelle                          | 1                            | 02010123  |
| F15    | Retaining ring                | Halte Ring                      | Anello ritegno                       | Anneau distance                   | 1                            | 04010306  |
| F16    | Pin                           | Federring                       | Anello elastico                      | Cheville                          | 1                            | 02010231  |
| F17    | Trip shift lever external     | Schalthebel aussen              | Leva scatto esterno                  | Levier déclenchement externe      | 2                            | 04010286  |
| F18    | Washer 0.7                    | Scheibe 0.7                     | Rondella 0.7                         | Rondelle 0.7                      | 4                            | 02010149  |
| F19    | Trip shift lever internal     | Schalthebel innen               | Leva scatto interna                  | Levier déclenchement interne      | 2                            | 04010287  |
| F20    | Nut M5                        | Mutter M5                       | Dado M5                              | Ecrou M5                          | 2                            | 02010129  |
| F21    | Washer 5                      | Scheibe 5                       | Rondella 5                           | Rondelle 5                        | 2                            | 02010040  |
| F22    | Shaft trip lever              | Sektorwelle                     | Perno leva settore                   | Pivot levier inversion            | 1                            | 04010307  |
| F23    | Trip shift lever VA           | Sektorhebel VA                  | Leva scatto settore VA               | Levier inversion VA               | 1                            | 04010311  |
| F24    | Washer                        | Scheibe                         | Rondella                             | Rondelle                          | 1                            | 04010194  |
| F25    | Bolt M8x20                    | Schraube M8x20                  | Vite M8x20                           | Vis M8x20                         | 1                            | 02010036  |
| F26    | Shaft sleeve                  | Welle für Hülse                 | Perno bussola                        | Pivot douille                     | 1                            | 04010305  |
| F27    | Plug sleeve                   | Kappe für Hülse                 | Tappo bussola                        | Bouchon douille                   | 1                            | 04010198  |
| F28    | Trip spring                   | Feder für Schaltung             | Molla scatto settore                 | Ressort inversion                 | 1                            | 02010117  |
| F29    | Spring sleeve                 | Federhülse                      | Bussola scatto settore               | Douille ressort                   | 1                            | 02010120  |
| F30    | Shaft sleeve                  | Welle für Hülse                 | Perno bussola                        | Pivot douille                     | 1                            | 04010304  |
| F31    | Guide for sleeve              | Gleitnuppe für Hülse            | Nottolino per bussola                | Taquet pour douille               | 1                            | 04010197  |
| F32    | Cross FC                      | Kreuzwelle FC                   | Crociera FC                          | Croisière FC                      | 1                            | 04010312  |
| F33    | Spacer                        | Distanzring                     | Distanziale                          | Entretoise                        | 2                            | 04010314  |
| G.00.0 | <b>Kit</b> Elbow 10'-26'      | <b>Kit</b> Kurve 10'-26'        | <b>Kit</b> Curva 10'-26'             | <b>Kit</b> Coude 10'-26'          | 1                            | 07010531  |
| G1     | Elbow 10'-26'                 | Kurve 10'-26'                   | Curva 10'-26'                        | Coude 10'-26'                     | 1                            | 04010281  |
| G3     | Lip seal                      | Lippen-Dichtung                 | Guarnizione a labbro                 | Joint à levre                     | 1                            | 02010239  |
| G4     | Nut M6                        | Mutter M6                       | Dado M6                              | Ecrou M6                          | 4                            | 02010128  |
| G5     | Washer 6                      | Scheibe 6                       | Rondella 6                           | Rondelle 6                        | 4                            | 02010042  |
| G6     | Nut M8                        | Mutter M8                       | Dado M8                              | Ecrou M8                          | 2                            | 02010038  |

Grey shaded part numbers: not available as single parts, please select appropriate kit/assembly • Grau hinterlegte Ersatzteile: einzeln nicht erhältlich, sondern nur im entsprechenden Ersatzteil-Kit • Pezzi di ricambio su fondo grigio: non fornibili singolarmente, selezionare il kit ricambio desiderato • Pièces de rechange sur fond gris: ne sont pas disponibles séparément, sélectionner le kit pièces souhaite • Las referencias sombreadas en gris: no están disponibles como piezas solas, por favor seleccione el equipo/conjunto apropiado apropiado • Peças com números sombreados de cinza: não disponíveis como peças individuais, por favor, selecione o conjunto/montagem apropriado.